



Part No. Legend

XXX - 000 - 000 - 0

Type of Panel		No of Ports		Connector Type		Type	
Rack Mount	E-P	4 port	4	FC	FC	Simplex	S
Wall Mount	E-WML	8 port	8	LC	LC	Duplex	D
ODF Series	ODF	12 port	12	SC	SC		
CDF Series	CDF	24 port	24	ST	ST		
Breakout Box	E-WMS	48 port	48	E2000	E20		
Rack Mount PLC Splitter	E-P-SPTR	72 Port	72				
Wall Mount PLC Splitter	E-WML-SPTR	96 Port	96				
		144 Port	144				
		288 Port	288				

Fiber Protection Sleeve



Ribbon type (8/12F)
L40mm



Simplex type
L40/45/60mm
Dia.2.0/2.5/3.0mm

Specification

Operation Temperature
-45 ~ 100 °C

Heat Shrink Temperature Range
90~110 °C

Standard	Testing reference	Typ. Data
Tensile Strength (MPa)	ASTM D 2671	≥18 MPa
Rupture elongate ratio (%)	ASTM D 2671	700%
Density(g/cm ³)	ISO R1183D	0.94g/cm ³
Intensity (KV/mm)	IEC 243	20 KV/mm
Constant	IEC 243	2.5 max.
Tolerance of length(%)	ASTM D 2671	0+5%

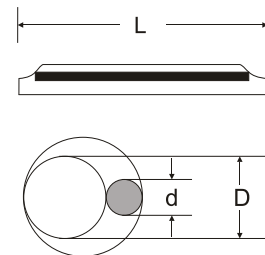

Part No. Legend

FSP - 00 - 0

Splice Protector	Type		Diameter
FSP	40mm	40	2.0mm
	45mm	45	2.5mm
	60mm	60	3.0mm